



PEN.1M.308.XLMT

MECHANICAL DETAILS

- Shell Style Model** PE* : Fixed receptacle nut fixing and mold stop
- Keying** 3 keys (beta=165, gamma=30, plug: male contacts, receptacle: female contacts)
- Housing Material** Environment friendly aluminium (nickel plated, anthracite color) shell and nut, other pieces bronze/brass
- Cable Fixing** 0 - 0 mm
- Variant 2** :

				A	B	C	D
Mm.				18.0	10.5	17.8	9.7
In.				0.71	0.41	0.70	0.38

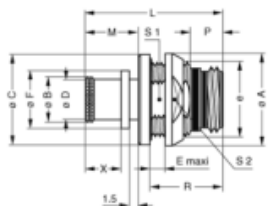

PERFORMANCE DETAIL

- Insert** 1M.308 : 8 Low Voltage
- Insulator**
- Specifications**
- Contact Type:** Crimp
- Max. Matings:** 5000
- Contact** 22 N
- Contact Dia.:** 0.7 mm (0.028in)
- Bucket Dia.:** 0.8 mm (0.031in)
- Min. Conductor:** 0.14 mm² (AWG 26)
- Max. Conductor:** 0.34 mm² (AWG 22)
- R (max):** 6.1 mOhm
- Extractor:** DCF.93.070.4LT
- Positioner:** DCE.91.070.3MM



OTHER CHARACTERISTICS

- Shell Style/Model** Libellé
- Humidity (max):** <=95% [at 60 deg C /140 F]
- Vibration:** 15 g [10 Hz - 2000 Hz]
- Shock Resistance:** 100 g [6 ms]
- Operating** -55°C/ +200°C
- Climatical** 15/200/21 (Al. shell)
- Lighting strike EIA** 10K amps - 6 times
- EMI Shielding EIA** - 1Ghz-80 dB,3GHz-70 dB,6GHz- 58dB
- IP Rating** 68

