



PEN.2M.310.XLMT

MECHANICAL DETAILS

- Shell Style Model** PE* : Fixed receptacle
nut fixing and mold stop
- Keying** 3 keys (beta=165, gamma=30,
plug: male contacts, receptacle:
female contacts)
- Housing Material** Environment friendly aluminium
(nickel plated, anthracite color)
shell and nut, other pieces
bronze/brass
- Cable Fixing** 0 - 0 mm
- Variant 2** :

| | | | | A | B | C | D |
|-----|--|--|--|------|------|------|------|
| Mm. | | | | 21.0 | 14.0 | 20.8 | 13.0 |
| In. | | | | 0.83 | 0.55 | 0.82 | 0.51 |

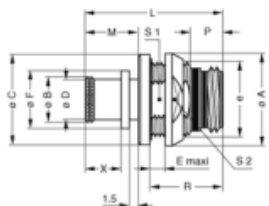

PERFORMANCE DETAIL

- Insert** 2M.310 : 10 Low Voltage
- Insulator**
- Specifications**
- Contact Type:** Crimp
- Max. Matings:** 5000
- Contact** 30 N
- Contact Dia.:** 0.9 mm (0.035in)
- Bucket Dia.:** 1.1 mm (0.043in)
- Min. Conductor:** 0.25 mm² (AWG 24)
- Max. Conductor:** 0.5 mm² (AWG 20)
- R (max):** 4.8 mOhm
- Extractor:** DCF.93.090.4LT
- Positioner:** DCE.91.090.3MM



OTHER CHARACTERISTICS

- Shell Style/Model** Libellé
- Humidity (max):** <=95% [at 60 deg C /140 F]
- Vibration:** 15 g [10 Hz - 2000 Hz]
- Shock Resistance:** 100 g [6 ms]
- Operating** -55°C/ +200°C
- Climatical** 15/200/21 (Al. shell)
- Lighting strike EIA** 10K amps - 6 times
- EMI Shielding EIA** - 1Ghz-80 dB,3GHz-70 dB,6GHz- 58dB
- IP Rating** 68

