



# FGS.2M.312.XLMT

## MECHANICAL DETAILS

**Shell Style Model** FG\* : Straight plug with arctic grip and mold stop

**Keying** 3 keys (beta=155, gamma=50, plug: female contacts, receptacle: male contacts)

**Housing Material** Environment friendly aluminium (nickel plated, anthracite color) shell and nut, other pieces bronze/brass

**Cable Fixing** 0 - 0 mm

**Variant 2** :

				A	B	C	D	F
Mm.				18.9	14.0	17.2	13.0	15.5
In.				0.74	0.55	0.68	0.51	0.61

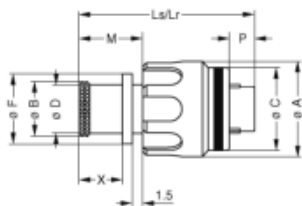

## PERFORMANCE DETAIL

**Insert** 2M.312 : 12 Low Voltage

**Insulator**

**Specifications**

**Contact Type:** Crimp

**Max. Matings:** 5000

**Contact** 22 N

**Contact Dia.:** 0.7 mm (0.028in)

**Bucket Dia.:** 0.8 mm (0.031in)

**Min. Conductor:** 0.14 mm<sup>2</sup> (AWG 26)

**Max. Conductor:** 0.34 mm<sup>2</sup> (AWG 22)

**R (max):** 6.1 mOhm

**Extractor:** DCF.93.070.4LT

**Positioner:** DCE.91.070.3MM

## OTHER CHARACTERISTICS

**Shell Style/Model** Libellé

**Humidity (max):** <=95% [at 60 deg C /140 F]

**Vibration:** 15 g [10 Hz - 2000 Hz]

**Shock Resistance:** 100 g [ 6 ms]

**Operating** -55°C / +200°C

**Climatical** 15/200/21 (Al. shell)

**Lighting strike EIA** 10K amps - 6 times

**EMI Shielding EIA** - 1Ghz-80 dB,3GHz-70 dB,6GHz- 58dB

**IP Rating** 68

